

Selber Design Inc.  
 675 Drewry St. NE  
 Studio 10  
 Atlanta GA 30306  
 404.875.6765

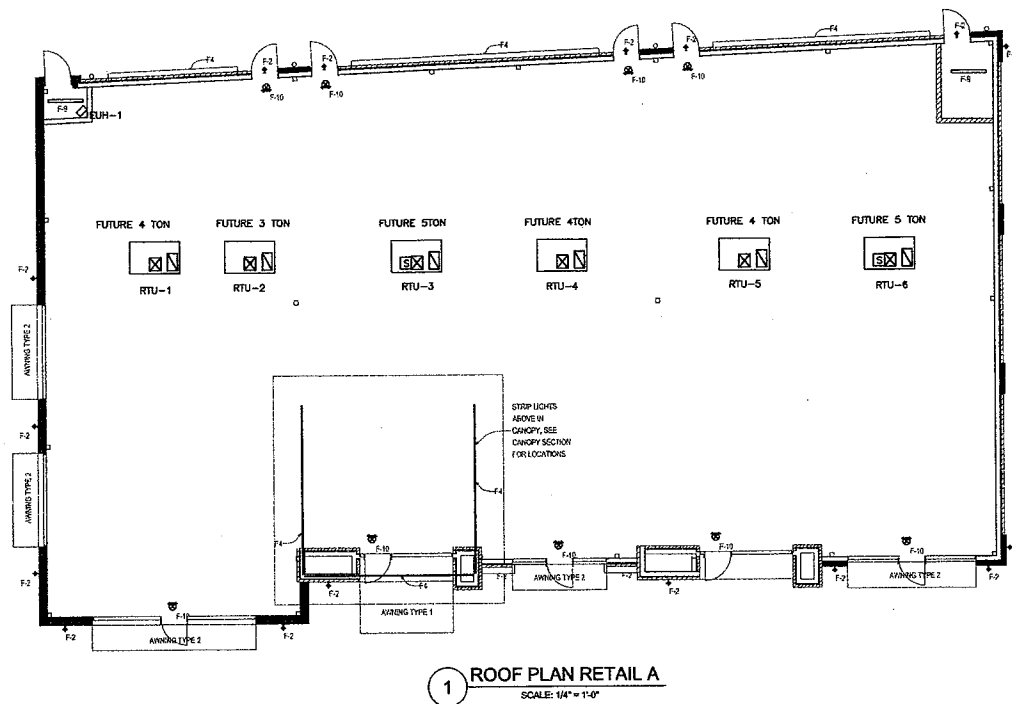
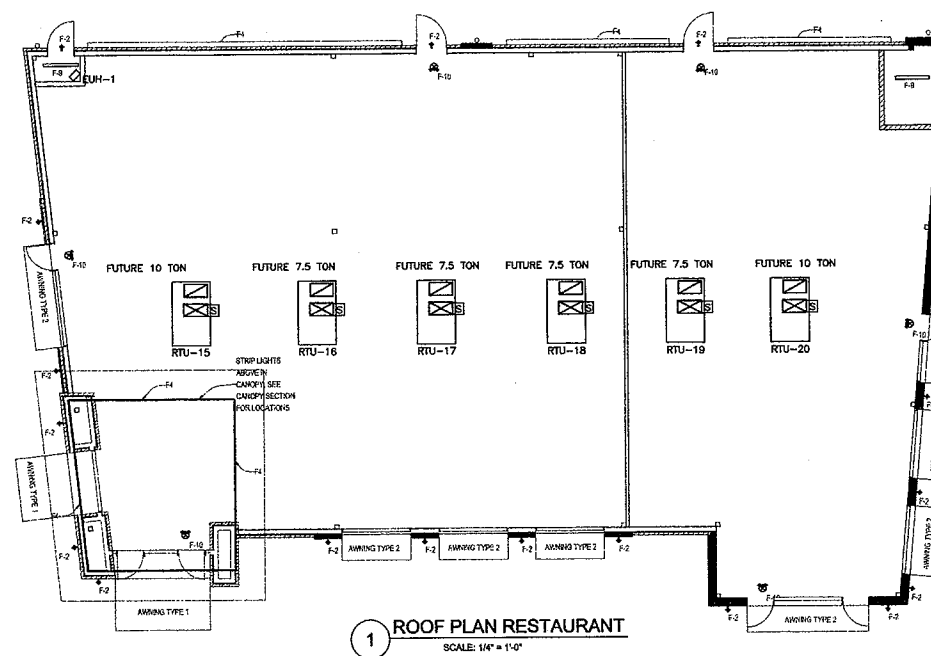
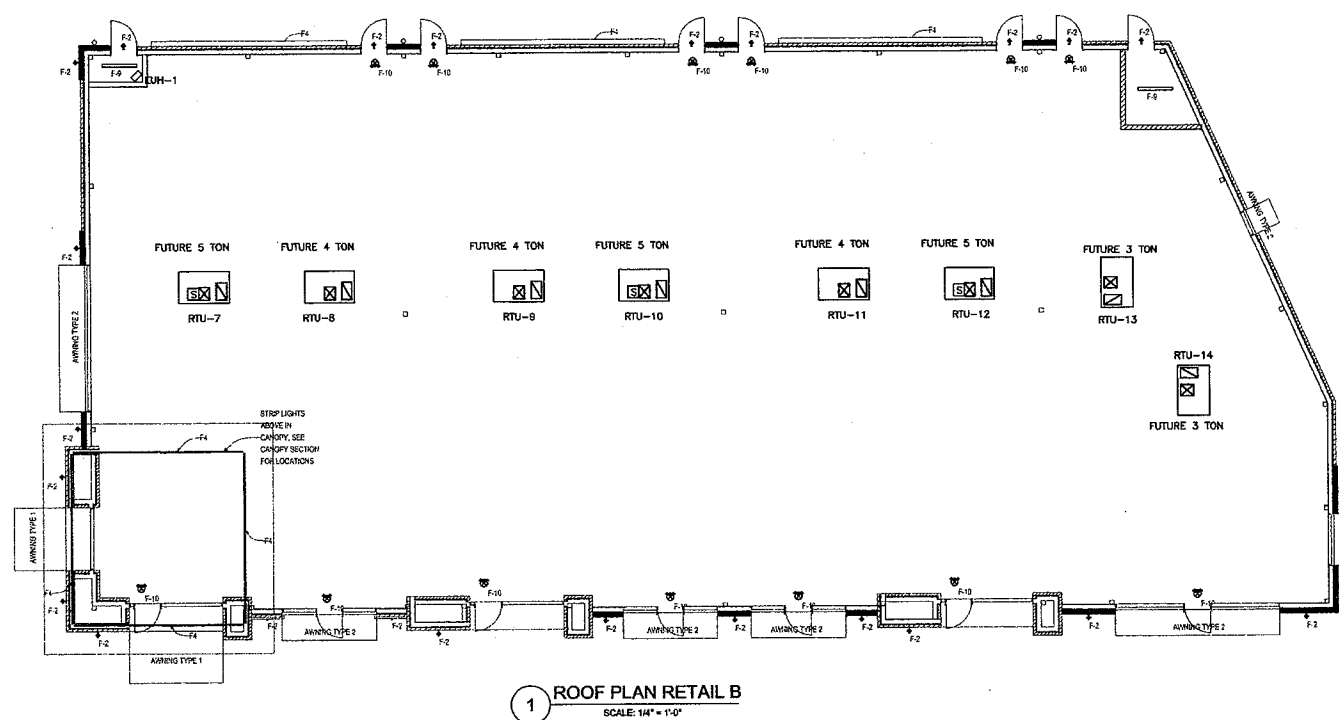

**PROPOSED FUTURE SINGLE PACKAGE AIR CONDITIONING UNIT SCHEDULE**

MARK	SUPPLY AIR		MIN. O.A.	COOLING CAPACITY (MIN.)				HEATING - NAT. GAS		ELECTRICAL		MFG. & MODEL	TONS	SEER/EER	APPROX. WEIGHT Lbs.	NOTES		
	CFM	E.S.P.		TOTAL MBH	SENS. MBH	EXT	LAT	MBH IN	MBH OUT	AFUE %	VOLTS						PHASE	
RTU-2,13,14	1200	0.75	275	37.2	27.8	55/54	80/67	60.0	48.0	80	208	3	TRANE	YSC038E3	3.0	13.0/-	750	SEE BELOW
RTU-1,4,5,8,9,11	1600	0.75	355	49.4	37.5	55/54	80/67	60.0	48.0	80	208	3	TRANE	YSC048E3	4.0	13.0/-	775	SEE BELOW
RTU-3,6,7,10,12	2000	0.75	445	62.3	48.1	55/54	80/67	60.0	48.0	80	208	3	TRANE	YSC060E3	5.0	13.0/-	775	SEE BELOW
RTU-16,17,18,19	3000	0.75	280	94.0	69.1	55/54	80/67	120.0	97.2	81	208	3	TRANE	YSC092E3	7.5	-/11.2	1150	SEE BELOW
RTU-15,20	4000	0.75	370	118.0	92.7	55/54	80/67	150.0	121.5	81	208	3	TRANE	YSC120E3	10.0	-/10.6	1300	SEE BELOW

NOTES:  
 ROOF CURB  
 MOTORIZED OUTSIDE AIR DAMPER  
 COIL GUARDS  
 ANTI-SHORT CYCLE TIMER  
 THROUGH THE BASE ELECTRICAL WITH DISCONNECT  
 CONVENIENCE OUTLET  
 7-DAY PROGRAMMABLE THERMOSTAT

**ELECTRIC WALL HEATER SCHEDULE**

NO.	LOCATION	KW	VOLTS/PH	MFG. & MODEL	NOTES
EMH-1	SPRINKLER ROOM	2.2	208/1	OMARK M4803-21	1, 2, 3, 4

NOTES:  
 1. WALL BRACKET  
 2. INTEGRAL DISCONNECT  
 3. AUTOMATIC THERMAL CUT-OUT RESET  
 4. INTEGRAL T-STAT

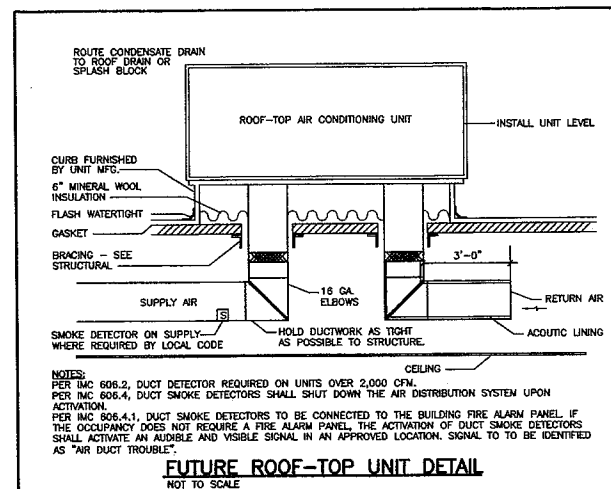

**GENERAL MECHANICAL NOTES:**

- MOUNT THERMOSTATS 48" ABOVE FINISH FLOOR TO CENTER DUCTWORK AND EQUIPMENT SHOWN IS DIAGRAMMATIC.
- COORDINATE AND ROUTE DUCT DROPS TO MEET JOB REQUIREMENTS. LOCATION OF EQUIPMENT MUST BE COORDINATED WITH ALL DISCIPLINES BEFORE FINAL LOCATIONS ARE SELECTED. WEIGHTS OF EQUIPMENT MUST BE VERIFIED AND COORDINATED WITH STRUCTURAL SYSTEMS BEFORE EQUIPMENT CAN BE INSTALLED AT JOBSITE.
- MECHANICAL DUCTWORK LAYOUT TO BE DETERMINED BY TENANT LAYOUT.
- WHERE THE SPACE ABOVE THE SUSPENDED CEILING IS USED AS A RETURN AIR PLENUM, COORDINATE THE WORK OF OTHER TRADES TO PROVIDE ADEQUATE SPACE FOR THE FLOW OF RETURN AIR (250 FPM MAXIMUM VELOCITY). WHERE PARTITIONS ARE EXTENDED TO THE STRUCTURE ABOVE, PROVIDE OPENINGS IN THE PARTITIONS ABOVE THE CEILING.
- ALL FIRE DAMPERS TO BE RATED AT 1-1/2 HOURS UNLESS INDICATED OTHERWISE. USE "B" FRAME FIRE DAMPERS FOR DAMPERS CONNECTED TO DUCTWORK.
- COORDINATE THE LOCATION OF CEILING DIFFUSERS, REGISTERS AND GRILLES WITH THE ARCHITECTURAL REFLECTED CEILING PLANS DURING TENANT FIT-OUT.
- FLEXIBLE RUNOUTS TO BE SAME SIZE AS DIFFUSER NECK. REFER TO DIFFUSER SCHEDULE.
- PASSAGES OF PIPES, CONDUITS, BUS DUCTS, CABLES, WIRES, AIRDUCTS, PNEUMATIC DUCTS, AND SIMILAR BUILDINGS SERVICE EQUIPMENT THROUGH FIRE BARRIERS SHALL BE PROTECTED AS FOLLOWS:  
 THE SPACE BETWEEN THE PENETRATING ITEM AND FIRE BARRIER SHALL BE FILLED WITH A MATERIAL CAPABLE OF MAINTAINING THE FIRE RESISTANCE RATING OF THE FIRE BARRIER PRODUCT. PRODUCT USED MUST MEET TEST METHODS ASTM E814 OR NFPA 251 FOR FIRE RATING.

THE CROSSING @ SIXES



MENTICK ENGINEERING, INC.  
 3585 Hobersham at Northlake  
 Tucker, Georgia 30084  
 TEL (770)-491-7848  
 FAX (770)-491-7856  
 27055

Revised History

Number	Date	Description
88-20-3077		RELEASE FOR PERMIT



Job Address  
 SIXES ROAD  
 CHEROKEE COUNTY, GA

Drawing Title  
 MECHANICAL PLAN

Drawing Status  
 NOT RELEASED FOR PERMIT

Drawing Number

M1.1