

MATERIAL LEGEND

SYMBOL	DESCRIPTION
	RIGID INSULATION
	EPS
	PLYWOOD
	CONCRETE
	SAND
	EARTH
	STEEL
	WOOD BLOCKING
	BATT INSULATION
	BRICK

DRAFTING SYMBOLS

SYMBOL	DESCRIPTION
	TITLE SYMBOL Example: Section 1 on sheet A31
	DETAIL - TYPICAL Example: Detail 2 on sheet A51
	ENLARGED DETAIL Example: Detail 4 on sheet A51
	INTERIOR ELEVATION SYMBOL Example: Interior elevation 1 on sheet FX101
	EXTERIOR ELEVATION SYMBOL Example: Exterior elevation 6 on sheet A21
	INTERIOR ROOM NUMBER
	INTERIOR ELEVATION ELEVATION IDENTIFICATION SHEET WHERE OCCURS
	DOOR SYMBOL
	FINISH ELEVATION SYMBOL
	PROJECT NORTH ARROW
	REVISION

ABBREVIATIONS

AFF.	ABOVE FINISH FLOOR	MAX.	MAXIMUM
ACOUS.	ACOUSTICAL	M.C.	MEDICINE CABINET
ADJ.	ADJUSTABLE	MECH.	MECHANICAL
AGGR.	AGGREGATE	MEPS.	METERS
ALUM.	ALUMINUM	MFR.	MANUFACTURER'S
AN.	ANCHOR BOLT	MTL.	METAL
ANG.	ANGLE	MIN.	MINIMUM
APPROX.	APPROXIMATE	MIR.	MIRROR
ALUM.	ALUMINUM	MISC.	MISCELLANEOUS
ARCH.	ARCHITECTURAL	MTD.	MOUNTED
AD.	AREA DRAIN	MUL.	MULLION
ASB.	ASBESTOS	NOV.	NOMINAL
ASPH.	ASPHALT	(N)	NEW
AT	AT	N.I.C.	NOT IN CONTRACT
BM.	BEAM	N.T.S.	NOT TO SCALE
BUILD.	BUILDING	NO.	NUMBER
BLK.	BLOCK	OB.	OBSCURE
BLKS.	BLOCKING	OFF.	OFFICE
BO.	BOARD	OC.	ON CENTER
BOT.	BOTTOM	OPNS.	OPENING
B.O.	BOTTOM OF BUILDING	OPP.	OPPOSITE
BLDG.	BUILDING	ODIA.	OUTSIDE DIAMETER
C.	CONTRACTOR	OA.	OVERALL
CAB.	CABINET	OD.	OVERFLOW DRAIN
CI.	CAST IRON	OS.	OVERFLOW SCUPPER
CB.	CATCH BASIN	OS.	OVERHEAD
CEM.	CEMENT	OS.	OWNER FURNISHED
CER.	CERAMIC	OS.	CONTRACTOR INSTALLED
CL.	CENTERLINE	OF.OI.	OWNER FURNISHED, OWNER INSTALLED
CLK.	CALLING	FR.	FIRE
CLS.	CEILING	FIN.	PARTITION
CL.	CHAIN LINK	PVIT.	PAVEMENT
CLR.	CLEAR	PA.	PLANTING AREA
CLO.	CLOSET	PL.	PLATE
CONTR.	CONTRACTOR	PRCST.	PRE-CAST
CO.	CASED OPENING	PLAS.	PLASTER
COL.	COLUMN	PL.LAM.	PLASTIC LAMINATE
CONC.	CONCRETE	FLUMB.	FLUMBER
CONN.	CONNECTION	PLYSD.	PLYWOOD
CONSTR.	CONSTRUCTION	PT.	POINT
CONT.	CONTINUOUS	F.MTL.	FRESSED METAL
CORR.	CORRIDOR	P.L.	PROPERTY LINE
CRK.	COUNTERSINK	QT.	QUARRY TILE
CTR.	CENTER	R	R VALUE
CT.	CERAMIC TILE	RAD.	RADIUS
DEPT.	DEPARTMENT	RULL.	RAIN WATER LEADER
DET.	DETAIL	RUDD.	REDWOOD
DIA.	DIAMETER	REF.	REFERENCE
DIM.	DIMENSION	REFR.	REFRIGERATOR
DISP.	DISPENSER	RSTR.	REGISTER
DR.	DOOR	REIN.	REINFORCED
DBL.	DOUBLE	REQ.	REQUIRED / REQUIREMENTS
DN.	DOWN	RESIL.	RESILIENT
D.S.	DOWNPOUT	RISER.	RISER
DWG.	DRAWING	R.	ROOF DRAIN
D.F.	DRINKING FOUNTAIN	RM.	ROOM
EA.	EACH	RO.	ROUGH OPENING
(E)	EXISTING	RS.	ROUGH SAWN
ELEC.	ELECTRICAL	R.D.	SCUPPER DRAIN
ELEC.	ELECTRIC WATER COOLER	SCH.	SCHEDULE
EL.	ELEVATION	SECT.	SECTION
ENCL.	ENCLOSURE	S.S.	STAINLESS STEEL
EP.	EPOXY TOPPING	SH.	SHIRT
EQUIP.	EQUIPMENT	SH.	SHELF
EXHA.	EXHAUST	SH.	SIMILAR
EXIST.	EXISTING	S.	SKN
EXP.	EXPANSION	S.C.	SOLID CORE
EJ.	EXPANSION JOINT	S.	SOUTH
EXP.	EXPOSED	SPEC.	SPECIFICATION
EXT.	EXTERIOR	SQ.	SQUARE
F.O.F.	FACE OF FINISH	SST.	STAINLESS STEEL
F.O.M.	FACE OF MASONRY	STD.	STANDARD
F.O.B.	FACE OF STUD	STA.	STATION
FR.	FACTORY FINISH	STL.	STEEL
FL.	FLOOR	STR.	STORAGE
F.D.	FLOOR DRAIN	STRUCT.	STRUCTURAL
F.A.R.	FLOOR AREA RATIO	SUSP.	SUSPENDED
FL.FN.	FLOOR FINISH	SUBRD.	SUBROARD
FS.	FLOOR FINISH	SYM.	SYMMETRICAL
FR.	FIRE RESTAVENT	T.	TREAD
FT.	FOOT OR FEET	TEL.	TELEPHONE
GALV.	GALVANIZED	TV.	TELEVISION
G.C.	GENERAL CONTRACTOR	TER.	TERRAZZO
G.S.	GALVANIZED STEEL	THK.	THICK
GI.	GALVANIZED IRON	T.P.D.	TOILET PAPER DISPENSER
GA.	GAUGE	T.O.	TOP OF
GL.	GLASS	T.O.C.	TOP OF CURB
GB.	GRAB BAR	T.O.P.	TOP OF PARAPET
GR.	GRADE	T.O.R.	TOP OF ROOF
GND.	GROUND	T.O.W.	TOP OF WALL
GYP.	GYPSEM WALLBOARD	TIG	TONGUE & GROOVE
H.C.	HANDICAPPED	TB.	TUBULAR
HDR.	HARDWARE	TYP.	TYPICAL
HDD.	HARDWOOD	UNF.	UNFINISHED
HGT.	HEADER	UNO.	UNLESS NOTED OTHERWISE
HDR.	HEIGHT	URN.	URNAL
H.M.	HOLLOW METAL	VEST.	VESTIBLE
HORIZ.	HORIZONTAL	VERT.	VERTICAL
HP.	HOSE PULLER	V.O.J.	VERIFY ON JOB
HR.	HOUR	W.SCT.	WANSCT
ID.	INSIDE DIAMETER	W.C.	WATER CLOSET
INFO.	INFORMATION	WP.	WATERPROOF
INT.	INTERIOR	WT.	WEIGHT
INSUL.	INSULATION	W.	WEST
JAN.	JANITOR	W/O.	WITHOUT
JT.	JOINT	WD.	WOOD
JST.	JOIST		
KIT.	KITCHEN		
L.	LANDLORD		
LAB.	LABORATORY		
LAM.	LAMINATE		
LAV.	LAVATORY		
LT.	LIGHT		
LKR.	LOCKER		
M.H.	MANHOLE		
MFR.	MANUFACTURER		
M.O.	MASONRY OPENING		

GENERAL NOTES

- THE FOLLOWING NOTES SHALL FORM A PART OF THIS WORK AND ARE THE RESPONSIBILITY OF EACH AND EVERY CONTRACTOR INVOLVED.
- ALL WORK AND FINAL FINISHED PRODUCTS SHALL BE COMPLETE IN EVERY RESPECT TO THE SATISFACTION OF THE OWNER.
- THESE DRAWINGS ARE PREPARED FOR THE PURPOSE OF CONSTRUCTION ONLY. THESE DRAWINGS ARE NOT TO BE USED FOR MAINTENANCE PURPOSES AS ACTUAL CONDITIONS MAY VARY FROM THOSE SHOWN ON THESE DRAWINGS DUE TO CHANGE ORDERS, ALTERATIONS BY OTHERS, FIELD CONDITIONS, ETC.
- CONTRACTOR SHALL FIELD VERIFY ALL DIMENSIONS AND LOCATIONS AFFECTING THIS PROJECT PRIOR TO FABRICATION OR INSTALLATION OF NEW WORK. NOTIFY ARCHITECT OF ANY DISCREPANCIES FROM DIMENSIONS SHOWN NOTED OR REQUIRED. ADJUST DIMENSIONS OF NEW CONSTRUCTION AT THE DIRECTION OF THE ARCHITECT TO ALLOW ACTUAL FIELD DIMENSIONS.
- ALL WORK MUST MEET THE REQUIREMENTS OF ALL APPLICABLE CODES, ORDINANCES AND THE APPROVAL OF THE GOVERNING AUTHORITY. THIS IS THE RESPONSIBILITY OF THE GENERAL CONTRACTOR (G.C.) AND ALL THE SUBCONTRACTORS.
- ALL DIMENSIONS ARE FINISH FACE TO FINISH FACE UNLESS NOTED OTHERWISE.
- ALL FIRE EXTINGUISHERS (MINIMUM CLASS 1A) WILL BE FURNISHED AND INSTALLED BY BELK DEPARTMENT STORES.
- ALL WOOD BLOCKING IS TO BE FIRE RETARDANT TREATED (FRT).
- THE PROJECT MANUAL AND SPECIFICATIONS IN CONNECTION WITH THESE DRAWINGS SHALL FORM A PART OF THE CONTRACT AND SHALL BE REFERRED TO AS THE "DOCUMENTS". THE DOCUMENTS DEFINE THE WORK TO BE PERFORMED AS AGREED TO IN THE CONTRACT.
- THE CONTRACTOR SHALL THOROUGHLY FAMILIARIZE HIMSELF WITH THE EXISTING CONDITIONS OF THE PROJECT SITE AND ADJACENCIES. ALL DISCREPANCIES OR CONFLICTS WITH THE INTENT OF THE DOCUMENTS AND THE SITE SHALL BE BROUGHT TO THE ATTENTION OF THE ARCHITECT FOR RESOLUTION. FAILURE TO NOTIFY THE ARCHITECT PRIOR TO BEGINNING THE WORK SHALL CONSTITUTE ACCEPTANCE OF THE CONDITIONS BY THE CONTRACTOR AND THE WORK SHALL BE COMPLETED AS DEFINED IN THE DOCUMENTS WITHOUT ADDITIONAL COST DUE TO THE DISCREPANCIES OR CONFLICTS.
- THE CONTRACTOR AND EACH SUBCONTRACTOR SHALL CONTACT THE LOCAL BUILDING AUTHORITY FOR PERMITS REQUIRED TO PERFORM THE WORK DEFINED IN THE DOCUMENTS. THE CONTRACTOR IS RESPONSIBLE FOR OBTAINING AND PAYING FOR ALL PERMITS PERTAINING TO HIS WORK.
- THE CONTRACTOR AND EACH SUBCONTRACTOR SHALL ACQUAINT HIMSELF WITH THE WORK OF OTHER TRADES WHOSE ACTIVITIES WILL ADD ON OR BE AFFECTED BY HIS WORK. HE SHALL CONSULT WITH THESE OTHER CONTRACTORS OR WORKMEN AND STUDY THEIR SHOP DRAWINGS IN ORDER TO COORDINATE THEIR EFFORT TOWARD AVOIDING MISTAKES, OMISSIONS, DISPUTES OR DELAYS.
- THE CONTRACTOR SHALL SUPERVISE AND DIRECT THE WORK AND HE SHALL BE SOLELY RESPONSIBLE FOR ALL CONSTRUCTION MEANS, METHODS, TECHNIQUES, SEQUENCES AND PROCEDURES.
- THE CONTRACTOR SHALL PROVIDE, INSTALL AND MAINTAIN ALL PROTECTIVE WALLS, FENCES AND BARRIERS TO SAFEGUARD THE PUBLIC FROM THE CONSTRUCTION WORK FOR THE ENTIRE TIME THE CONSTRUCTION IS IN PROGRESS.
- THE CONTRACTOR AND EACH SUBCONTRACTOR SHALL MAKE FIELD MEASUREMENTS NECESSARY FOR THIS WORK AND BE RESPONSIBLE FOR THEIR ACCURACY. VERIFY ALL DIMENSIONS, GRADES AND CONDITIONS OF THE WORK BEFORE AND DURING CONSTRUCTION.
- THE LOCATION OF ALL STAGING, PARKING, LOADING AND STORAGE OF MATERIALS, EQUIPMENT AND EMPLOYEES ON THE SITE SHALL BE VERIFIED WITH AND APPROVED IN WRITING BY THE OWNER.
- THE CONTRACTOR AND EACH SUBCONTRACTOR SHALL REVIEW STRUCTURAL, MECHANICAL (HVAC), PLUMBING, ELECTRICAL, AND INTERIOR DRAWINGS FOR CURBS, PADS, WALL OPENINGS, BLOCKING IN WALLS, CEILING OPENINGS AND ROOF OPENINGS FOR SIZE, LOCATION AND APPLICABLE DETAILS. VERIFY FINAL ITEMS WITH SELECTED SUPPLIERS. ALL SUCH WORK IS PART OF THE WORK.
- VERIFY ALL DIMENSIONS AT THE SITE.
- DO NOT SCALE THE DRAWINGS.
- EXTERIOR GRADE, PAVEMENT OR SOIL SHALL SLOPE AWAY FROM THE BUILDING.
- NO PIPES, DUCTS, SLEEVES, CHASSES OR CONDUIT SHALL BE PLACED IN CONCRETE SLABS, CONCRETE BEAMS OR CONCRETE BLOCK WALLS UNLESS SPECIFICALLY SHOWN OR NOTED OTHERWISE.
- STRUCTURAL MEMBERS SHALL NOT BE CUT FOR PIPES, DUCTS, SLEEVES, CHASSES OR CONDUIT UNLESS SPECIFICALLY SHOWN OR NOTED.
- THE CONTRACTOR SHALL DETERMINE THE LOCATION OF UTILITY SERVICES IN THE AREA TO BE EXCAVATED PRIOR TO BEGINNING EXCAVATION.
- NO DAMAGE TO EXISTING CONSTRUCTION DAMAGED DURING THE PERFORMANCE OF THIS WORK SHALL BE REPAIRED AT THE CONTRACTOR'S EXPENSE.
- THE CONTRACTOR AND EACH SUBCONTRACTOR SHALL CONFORM TO APPLICABLE OSHA CONSTRUCTION SAFETY ORDERS AND RELATED SAFETY REGULATIONS FOR THE ENTIRE TIME THAT CONSTRUCTION IS IN PROGRESS.
- THE CONTRACTOR SHALL PROVIDE AND MAINTAIN TEMPORARY SANITARY TOILET FACILITIES ON SITE FOR THE ENTIRE TIME THAT CONSTRUCTION IS IN PROGRESS.
- THE CONTRACTOR SHALL MAINTAIN THE SITE, BUILDING(S) AND ADJACENT STREETS CLEAN AND FREE OF ACCUMULATION OF CONSTRUCTION DEBRIS.

To order plans, go to www.idirepco.com

A:\csh\current\proj\Belk\0296 Belk\0296 Belk\0296 Construction Drawings\0296 Arch Sheets\0296-02.dwg 3/19/16

BELK ARCHITECTURAL CONSTRUCTION SERVICES, INC.
 4000 BELK BLVD., SUITE 1000
 OXFORD, MISSISSIPPI 39075
 P 662.231.9000
 F 662.231.9555

NO.	DATE	BY	DESCRIPTION
1	3/19/16

BELK DEPARTMENT STORES
 OXFORD GALLERIA
 OXFORD, MISSISSIPPI
 NEW STORE

NOTES, SYMBOLS AND ABBREVIATIONS

NO.	DATE	BY	DESCRIPTION
1	3/19/16

OF SHEETS
 ARCHITECTURAL SHEET NUMBER
002
 OF SHEETS

To order plans, go to www.idirepro.com

\\fs1\current\plans\Belk\1996 Defend. H5\08 Construction Drawings\088 Arch. Sheets\396-C03.dwg

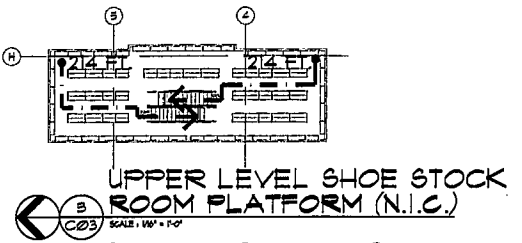
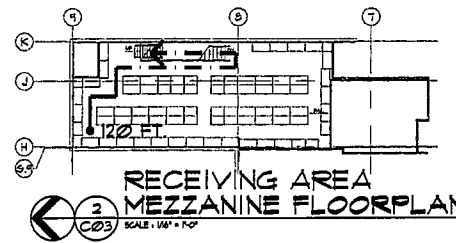
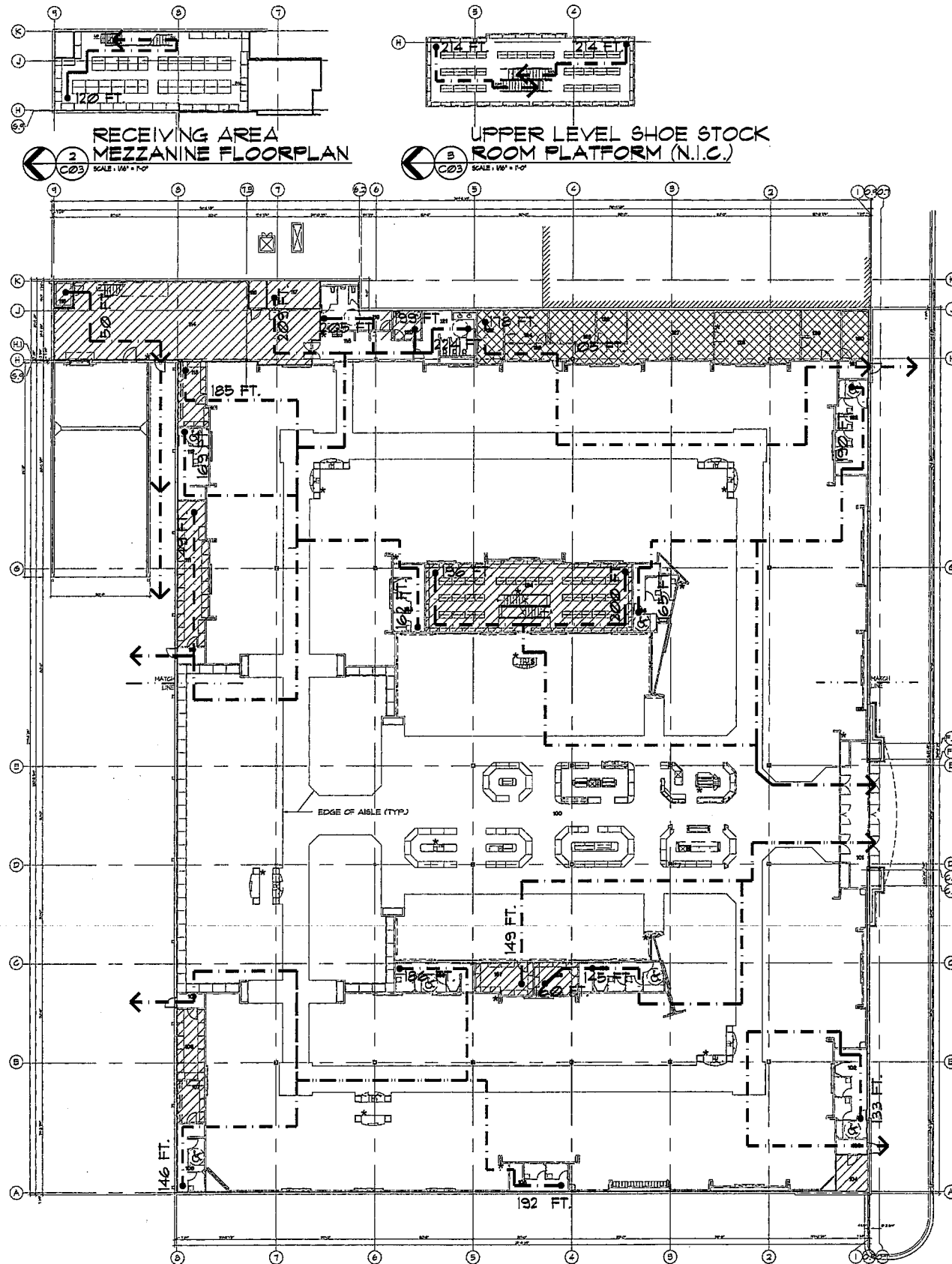

ROOM LEGEND

100	GENERAL SALES
101	VESTIBULE
102	FITTING ROOM
103	VESTIBULE
104	ELECTRICAL ROOM
105	FITTING ROOM
106	FITTING ROOM
107	STOCKROOM
108	STOCKROOM
109	VESTIBULE
110	VESTIBULE
111	STOCKROOM
112	FITTING ROOM
113	STOCKROOM
114	RECEIVING
115	SPRINKLER ROOM
116	ELECTRICAL ROOM
117	ELECTRICAL ROOM
118	CREDIT CORRIDOR
119	MENS RESTROOM
120	JANITOR CLOSET
121	WOMENS RESTROOM
122	TELECOM ROOM
123	CORRIDOR
124	CASH OFFICE
125	STORE MANAGER
126	INTERVIEW / TRAINING
127	ASH LOCKER ROOM
128	EMPLOYEE LOUNGE
129	COATS/LOCKERS
130	SECURITY
131	VESTIBULE
132	FITTING ROOM
133	FITTING ROOM
134	SHOE STOCK ROOM
135	FITTING ROOM
136	FITTING ROOM
137	STOCKROOM
138	STOCKROOM
139	FITTING ROOM

Belk
ACE ARCHITECTURAL CONSULTANTS SERVICES, INC.
1118 WEST 11TH STREET
OKLAHOMA CITY, OKLAHOMA 73101
P 405.451.6600
F 405.451.9855

LEGEND

SALES AREA
STORAGE, MECH./EQUIP.
BUSINESS

CLASS A HAZARD, ORDINARY (MODERATE) HAZARD OCCUPANCY
3000 SQ FT OF A
REQUIRED: 13
PROPOSED: 26
* = FIRE EXTINGUISHER LOCATION

EXIT DATA

TOTAL NUMBER OF OCCUPANT CALCULATION

MERCANTILE AREA:	50,038 SF. @ 30 SF/PERSON	1,681 PEOPLE
S-I, STORAGE:	4,355 SF. @ 300 SF/PERSON	11 PEOPLE
BUSINESS:	1,631 SF. @ 100 SF/PERSON	16 PEOPLE
TOTAL:	57,424 SF.	1,708 PEOPLE

SALES AREA - TOTAL EXIT WIDTH REQUIRED WITH SPRINKLER SYSTEM:
1,708 PEOPLE X 18 INCH/PERSON = 307 INCHES = (8) 3' OPENINGS AT 34' CLEAR OPENINGS

PROVIDED EXIT WIDTH = 408 INCHES

MAXIMUM TRAVEL DISTANCE WITH SPRINKLER SYSTEM = 250'

DEAD END LIMIT = 20'

MINIMUM CORRIDOR WIDTH = 3'-8"

EXIT PLAN ANALYSIS

EXIT	NO.	TYPE	AREA	PEOPLE	STATUS
1	1	EXIT	100	100	OK
2	2	EXIT	100	100	OK
3	3	EXIT	100	100	OK
4	4	EXIT	100	100	OK
5	5	EXIT	100	100	OK
6	6	EXIT	100	100	OK
7	7	EXIT	100	100	OK
8	8	EXIT	100	100	OK
9	9	EXIT	100	100	OK
10	10	EXIT	100	100	OK
11	11	EXIT	100	100	OK
12	12	EXIT	100	100	OK
13	13	EXIT	100	100	OK
14	14	EXIT	100	100	OK
15	15	EXIT	100	100	OK
16	16	EXIT	100	100	OK
17	17	EXIT	100	100	OK
18	18	EXIT	100	100	OK
19	19	EXIT	100	100	OK
20	20	EXIT	100	100	OK
21	21	EXIT	100	100	OK
22	22	EXIT	100	100	OK
23	23	EXIT	100	100	OK
24	24	EXIT	100	100	OK
25	25	EXIT	100	100	OK
26	26	EXIT	100	100	OK
27	27	EXIT	100	100	OK
28	28	EXIT	100	100	OK
29	29	EXIT	100	100	OK
30	30	EXIT	100	100	OK
31	31	EXIT	100	100	OK
32	32	EXIT	100	100	OK
33	33	EXIT	100	100	OK
34	34	EXIT	100	100	OK
35	35	EXIT	100	100	OK
36	36	EXIT	100	100	OK
37	37	EXIT	100	100	OK
38	38	EXIT	100	100	OK
39	39	EXIT	100	100	OK
40	40	EXIT	100	100	OK
41	41	EXIT	100	100	OK
42	42	EXIT	100	100	OK
43	43	EXIT	100	100	OK
44	44	EXIT	100	100	OK
45	45	EXIT	100	100	OK
46	46	EXIT	100	100	OK
47	47	EXIT	100	100	OK
48	48	EXIT	100	100	OK
49	49	EXIT	100	100	OK
50	50	EXIT	100	100	OK
51	51	EXIT	100	100	OK
52	52	EXIT	100	100	OK
53	53	EXIT	100	100	OK
54	54	EXIT	100	100	OK
55	55	EXIT	100	100	OK
56	56	EXIT	100	100	OK
57	57	EXIT	100	100	OK
58	58	EXIT	100	100	OK
59	59	EXIT	100	100	OK
60	60	EXIT	100	100	OK
61	61	EXIT	100	100	OK
62	62	EXIT	100	100	OK
63	63	EXIT	100	100	OK
64	64	EXIT	100	100	OK
65	65	EXIT	100	100	OK
66	66	EXIT	100	100	OK
67	67	EXIT	100	100	OK
68	68	EXIT	100	100	OK
69	69	EXIT	100	100	OK
70	70	EXIT	100	100	OK
71	71	EXIT	100	100	OK
72	72	EXIT	100	100	OK
73	73	EXIT	100	100	OK
74	74	EXIT	100	100	OK
75	75	EXIT	100	100	OK
76	76	EXIT	100	100	OK
77	77	EXIT	100	100	OK
78	78	EXIT	100	100	OK
79	79	EXIT	100	100	OK
80	80	EXIT	100	100	OK
81	81	EXIT	100	100	OK
82	82	EXIT	100	100	OK
83	83	EXIT	100	100	OK
84	84	EXIT	100	100	OK
85	85	EXIT	100	100	OK
86	86	EXIT	100	100	OK
87	87	EXIT	100	100	OK
88	88	EXIT	100	100	OK
89	89	EXIT	100	100	OK
90	90	EXIT	100	100	OK
91	91	EXIT	100	100	OK
92	92	EXIT	100	100	OK
93	93	EXIT	100	100	OK
94	94	EXIT	100	100	OK
95	95	EXIT	100	100	OK
96	96	EXIT	100	100	OK
97	97	EXIT	100	100	OK
98	98	EXIT	100	100	OK
99	99	EXIT	100	100	OK
100	100	EXIT	100	100	OK

EXIT ANALYSIS PLAN
SCALE: 1/16" = 1'-0"

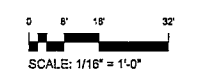

PROVIDED EXITS

EXIT	NO.	TYPE	AREA	PEOPLE	STATUS
1	1	EXIT	100	100	OK
2	2	EXIT	100	100	OK
3	3	EXIT	100	100	OK
4	4	EXIT	100	100	OK
5	5	EXIT	100	100	OK
6	6	EXIT	100	100	OK
7	7	EXIT	100	100	OK
8	8	EXIT	100	100	OK
9	9	EXIT	100	100	OK
10	10	EXIT	100	100	OK
11	11	EXIT	100	100	OK
12	12	EXIT	100	100	OK
13	13	EXIT	100	100	OK
14	14	EXIT	100	100	OK
15	15	EXIT	100	100	OK
16	16	EXIT	100	100	OK
17	17	EXIT	100	100	OK
18	18	EXIT	100	100	OK
19	19	EXIT	100	100	OK
20	20	EXIT	100	100	OK
21	21	EXIT	100	100	OK
22	22	EXIT	100	100	OK
23	23	EXIT	100	100	OK
24	24	EXIT	100	100	OK
25	25	EXIT	100	100	OK
26	26	EXIT	100	100	OK
27	27	EXIT	100	100	OK
28	28	EXIT	100	100	OK
29	29	EXIT	100	100	OK
30	30	EXIT	100	100	OK
31	31	EXIT	100	100	OK
32	32	EXIT	100	100	OK
33	33	EXIT	100	100	OK
34	34	EXIT	100	100	OK
35	35	EXIT	100	100	OK
36	36	EXIT	100	100	OK
37	37	EXIT	100	100	OK
38	38	EXIT	100	100	OK
39	39	EXIT	100	100	OK
40	40	EXIT	100	100	OK
41	41	EXIT	100	100	OK
42	42	EXIT	100	100	OK
43	43	EXIT	100	100	OK
44	44	EXIT	100	100	OK
45	45	EXIT	100	100	OK
46	46	EXIT	100	100	OK
47	47	EXIT	100	100	OK
48	48	EXIT	100	100	OK
49	49	EXIT	100	100	OK
50	50	EXIT	100	100	OK
51	51	EXIT	100	100	OK
52	52	EXIT	100	100	OK
53	53	EXIT	100	100	OK
54	54	EXIT	100	100	OK
55	55	EXIT	100	100	OK
56	56	EXIT	100	100	OK
57	57	EXIT	100	100	OK
58	58	EXIT	100	100	OK
59	59	EXIT	100	100	OK
60	60	EXIT	100	100	OK
61	61	EXIT	100	100	OK
62	62	EXIT	100	100	OK
63	63	EXIT	100	100	OK
64	64	EXIT	100	100	OK
65	65	EXIT	100	100	OK
66	66	EXIT	100	100	OK
67	67	EXIT	100	100	OK
68	68	EXIT	100	100	OK
69	69	EXIT	100	100	OK
70	70	EXIT	100	100	OK
71	71	EXIT	100	100	OK
72	72	EXIT	100	100	OK
73	73	EXIT	100	100	OK
74	74	EXIT	100	100	OK
75	75	EXIT	100	100	OK
76	76	EXIT	100	100	OK
77	77	EXIT	100	100	OK
78	78	EXIT	100	100	OK
79	79	EXIT	100	100	OK
80	80	EXIT	100	100	OK
81	81	EXIT	100	100	OK
82	82	EXIT	100	100	OK
83	83	EXIT	100	100	OK
84	84	EXIT	100	100	OK
85	85	EXIT	100	100	OK
86	86	EXIT	100	100	OK
87	87	EXIT	100	100	OK
88	88	EXIT	100	100	OK
89	89	EXIT	100	100	OK
90	90	EXIT	100	100	OK
91	91	EXIT	100	100	OK
92	92	EXIT	100	100	OK
93	93	EXIT	100	100	OK
94	94	EXIT	100	100	OK
95	95	EXIT	100	100	OK
96	96	EXIT	100	100	OK
97	97	EXIT	100	100	OK
98	98	EXIT	100	100	OK
99	99	EXIT	100	100	OK
100	100	EXIT	100	100	OK

PROJECT: DEPARTMENT STORES
OXFORD GALLERY
OXFORD, MISSISSIPPI
NEW STORE

EXIT PLAN ANALYSIS

ARCHITECTURAL
SHEET NUMBER
C03
OF SHEETS