

OPERATION AND MAINTENANCE INSTRUCTIONS AND GUIDELINES

- 1) ALL STORM WATER PIPES, INLETS, CATCH BASINS, MANHOLES, FLUMES, POND INFLOW AND OUTFLOW STRUCTURES, INCLUDING OIL SUMMERS AND DISCHARGES, SHOULD BE INSPECTED ON A REGULAR BASIS (MONTHLY) AND AFTER SEVERE RAINFALLS. THEY SHOULD BE MAINTAINED TO OPERATE AS DESIGNED BY REMOVING BUILT UP DEBRIS AND VEGETATION FROM INLETS, OUTFLOWS, AND CULVERTS. REPAIR DETERIORATED STRUCTURES IMMEDIATELY.
- 2) NO CHEMICAL, OIL, GREASE, OR SIMILAR WASTE SHALL BE DISPOSED OF DIRECTLY OR INDIRECTLY THROUGH STORM SEWERS TO THE STORMWATER FACILITY. TREATMENT PONDS ARE DESIGNED TO REMOVE NORMAL ROAD, PARKING LOT, ROOF, AND YARD RUNOFF ONLY.
- 3) NO ALTERATION OF ANY PART OF THE STORMWATER FACILITIES IS PERMITTED WITHOUT PRIOR APPROVAL FROM ALL APPLICABLE GOVERNING AGENCIES.

EROSION CONTROL

- 1) EROSION/SEDIMENTATION CONTROL - THE CONTRACTOR IS TO PROVIDE EROSION CONTROL/SEDIMENTATION BARRIERS (HAY BALES OR SILTATION CURTAIN) TO PREVENT SILTATION OF ADJACENT PROPERTY, STREETS, STORM SEWERS, AND WATERWAYS. IN ADDITION, THE CONTRACTOR SHALL PLACE STRAW, MULCH, GRAVEL, OR OTHER SIMILAR MATERIAL ON THE GROUND IN AREAS WHERE CONSTRUCTION RELATED TRAFFIC IS TO ENTER AND EXIT THE SITE. IF, IN THE OPINION OF THE ENGINEER AND/OR LOCAL AUTHORITIES, EXCESSIVE QUANTITIES OF EARTH ARE TRANSPORTED OFF-SITE EITHER BY NATURAL DRAINAGE OR BY VEHICULAR TRAFFIC, THE CONTRACTOR IS TO REMOVE AND CLEAN SAID EARTH TO THE SATISFACTION OF THE ENGINEER AND/OR AUTHORITIES.
- 2) THE CONTRACTOR SHALL GRASS ALL DISTURBED AREAS. IT IS THE RESPONSIBILITY OF THE CONTRACTOR TO MAINTAIN THESE DISTURBED AREAS UNTIL STABILIZATION OCCURS.
- 3) THE CONTRACTOR SHALL PLANT GRASS DURING CONSTRUCTION SO AS TO CONTROL EROSION.
- 4) EXTREME CAUTION SHALL BE TAKEN IN AREAS THAT DRAIN DIRECTLY INTO LAKE TUSCALOOSA. TWO LINES OF SILT FENCING SHALL BE REQUIRED IN THESE AREAS. SEE CONSTRUCTION PLANS.
- 5) THE CONTRACTOR SHALL INSPECT ALL EROSION CONTROL MEASURES AFTER EACH RAINFALL EVENT IN EXCESS OF 0.4" AND CLEAN AND REPAIR ANY AND ALL FAILED CONTROLS AND REMOVE EXCESS SEDIMENT FROM BEHIND CHECK DAMS AND SILT FENCING.

GENERAL NOTES

- 1) THE CONTRACTOR SHALL GIVE A 24-HOUR ADVANCED WRITTEN NOTICE TO ALABAMA SOUTHERN COMMUNITY COLLEGE PRIOR TO BEGINNING WORK ON EACH PHASE OF CONSTRUCTION.
- 2) THE CONTRACTOR SHALL BE RESPONSIBLE FOR OBTAINING ALL PERMITS FROM THE OWNER PRIOR TO COMMENCEMENT OF CONSTRUCTION AND THOROUGHLY REVIEWING AND UNDERSTANDING ALL PERMIT CONDITIONS. ALL WORK SHALL COMPLY WITH THE REQUIREMENTS OF THE PERMITS. ANY ADDITIONAL CONSTRUCTION/BUILDING PERMITS REQUIRED TO EXECUTE/COMPLETE THE WORK SHOWN IN THESE DOCUMENTS SHALL BE OBTAINED BY THE CONTRACTOR.
- 3) ALL CONSTRUCTION MATERIALS AND METHODS SHALL CONFORM TO THE LATEST EDITION OF CITY & COUNTY LAND DEVELOPMENT REGULATIONS AND TECHNICAL STANDARDS.
- 4) THE CONTRACTOR SHALL BE RESPONSIBLE FOR COORDINATING ALL WORK WITH THE SUBCONTRACTORS AND OTHER PUBLIC OR PRIVATE UTILITIES CONSTRUCTING FACILITIES WITHIN THE PROJECT LIMITS.
- 5) EXISTING UNDERGROUND UTILITY LINES SHOWN ON THE DRAWINGS WERE TAKEN FROM RECORD DRAWINGS AND DOCUMENTS FURNISHED BY OTHERS. THESE UTILITIES MAY OR MAY NOT HAVE BEEN FIELD VERIFIED. THE CONTRACTOR SHALL VERIFY THE LOCATION OF ALL UNDERGROUND UTILITIES WHICH MAY BE AFFECTED BY THE PROPOSED CONSTRUCTION. PRIOR TO ACTUAL CONSTRUCTION, THE ENGINEER SHALL BE IMMEDIATELY NOTIFIED IF A CONFLICT EXISTS BETWEEN ACTUAL FIELD CONDITIONS AND THESE PLANS. CALL ALABAMA ONE CALL AT 1-800-222-8525 MINIMUM 48 HOURS PRIOR TO DIGGING.
- 6) THE CONTRACTOR SHALL COORDINATE ALL CONSTRUCTION, INCLUDING TESTING, WITH ENGINEER AND APPROPRIATE CITY AND COUNTY INSPECTORS IN ACCORDANCE WITH THOSE MUNICIPALITY REGULATIONS.
- 7) THE CONTRACTOR SHALL BE RESPONSIBLE FOR OBTAINING ANY PERMITS THAT ARE NOT PROVIDED BY THE ENGINEER OR OWNER. THESE PERMITS MAY BE ROAD CLOSURES, ONE-WAY PERMITS, UTILITY, SITE CLEARING, AND LAND PERMITS FROM THE APPROPRIATE GOVERNMENT AGENCIES HAVING JURISDICTION OVER THE PROJECT SITE.
- 8) THE CONTRACTOR SHALL REPLACE ALL EXISTING PAVING, CURBS, SIDEWALKS, NAIL BOXES, DRIVEWAYS, FENCES, SIGNS, LIGHTS, CULVERTS, STABILIZE EARTH, AND OTHER IMPROVEMENTS WITH THE SAME OR BETTER TYPE OF MATERIAL THAT WAS REMOVED DURING THE CONSTRUCTION OR AS DIRECTED BY THE ENGINEER.
- 9) THE CONTRACTOR SHALL BE RESPONSIBLE FOR FURNISHING ALL FIELD TESTING, WITH ENGINEER AND APPROPRIATE CITY AND COUNTY INSPECTORS IN ACCORDANCE WITH THOSE MUNICIPALITY REGULATIONS. RECORD DRAWINGS, A MARK-UP "IN RED" SET OF PLANS SHALL BE AVAILABLE AT ALL TIMES AT THE CONSTRUCTION SITE. FINAL FIELD CONDITIONS SHALL BE SURVEYED BY A LICENSED SURVEYOR.
- 10) ALL PAVEMENT CUT/FILLING SHALL BE CONSTRUCTED PER THE STANDARD DETAILS LOCATED ON THE PLANS.
- 11) THE INFORMATION PROVIDED ON THESE PLANS IS SOLELY TO ASSIST THE CONTRACTOR IN ASSESSING THE NATURE AND EXTENT OF THE CONDITIONS WHICH MAY BE ENCOUNTERED DURING THE COURSE OF WORK. ALL CONTRACTORS ARE DIRECTED, THROUGH THE PREPARATION OF RECORD DRAWINGS, TO CONDUCT INVESTIGATIONS TO CONDUCT WHATEVER INVESTIGATIONS THEY MAY DEEM NECESSARY TO ARRIVE AT THEIR OWN CONCLUSIONS REGARDING THE ACTUAL CONDITIONS THAT WILL BE ENCOUNTERED, AND THEIR BIDS WILL BE BASED UPON.

SITE PREPARATION AND EARTHWORK NOTES

- 1) GENERAL - ALL WORKMANSHIP, MATERIALS, AND EQUIPMENT SHALL BE IN ACCORDANCE WITH THE APPLICABLE PORTIONS OF THE ALABAMA DEPARTMENT OF TRANSPORTATION (ADOT), STANDARDS AND SPECIFICATIONS FOR ROAD AND BRIDGE CONSTRUCTION, LATEST EDITION, ALDOT ROADWAY AND TRAFFIC DESIGN STANDARDS, LATEST EDITION AND THE CITY OF TUSCALOOSA REQUIREMENTS AND SPECIFICATIONS.
- 2) EXCAVATION - CONTRACTOR SHALL PROVIDE SHORING, SHEETING, AND BRACING AS MAY BE NECESSARY TO PROPERLY ACCOMPLISH THIS WORK. UNDERGROUND UTILITIES TO REMAIN FROM DAMAGE, SHOULD ANY UTILITIES BE ENCOUNTERED THAT ARE NOT INDICATED ON THE PLANS NOTIFY THE OWNER'S REPRESENTATIVE.
- 3) DISPOSAL SURPLUS MATERIAL FROM EXCAVATIONS, TRASH, DEBRIS AND MATERIALS RESULTING FROM CLEARING, GRUBBING, AND OTHER OPERATIONS SHALL BECOME THE PROPERTY OF CONTRACTOR AND SHALL BE DISPOSED OF BY REMOVING FROM THE SITE.
- 4) CLEARING AND GRUBBING: CLEAR AND GRUB TO REMOVE STUMPS, ROOTS, TREES, VEGETATION, ORGANIC MATERIALS, EXISTING PAVEMENT, STRUCTURES AND OTHER OBSTRUCTIONS TO THE WORKSITE. ALL ORGANIC SOILS OR MUCK SHALL BE REMOVED AND BACKFILLED WITH SUITABLE MATERIALS.
- 5) STRIP THE TOPSOIL FROM ALL AREAS WITHIN THE LIMITS OF CLEARING AND GRUBBING AND STOCKPILE ON THE SITE. TOPSOIL MAY BE SPREAD OVER AREAS OUTSIDE BUILDING AND PAVING LINES UPON COMPLETION OF ROUGH GRADING.
- 6) GRADING - GRADE THE SITE TO THE FINISHED CONTOURS INDICATED ON THE PLANS. IMMEDIATELY BEFORE REQUESTING FINAL INSPECTIONS, CHECK THE LINES AND CONTOURS TO THE PROPER CONTOURS. ALL AREAS ARE TO BE STABILIZED. THESE AREAS ARE TO BE MAINTAINED UNTIL ACCEPTANCE BY THE OWNER. WHEN SOIL, PLANT BEDS, GRAVEL AREAS AND THE LIKE ARE INDICATED ON LANDSCAPING DRAWINGS OR SPECIFIED, MAKE ALLOWANCES WHEN ROUGH GRADING FOR THE FINISHED GRADES IN THESE AREAS.
- 7) SUBSTRATE EXCAVATED MATERIAL, AS DETERMINED BY THE OWNER'S REPRESENTATIVE, MAY BE USED FOR GRADING. PROCURE ADDITIONAL MATERIALS, WHERE NECESSARY, FROM BORROW PITS APPROVED BY THE OWNER'S REPRESENTATIVE. FURNISH AT NO ADDITIONAL COST TO THE OWNER. BORROW MATERIALS SHALL HAVE PLASTIC INDEX OF SIX (6) OR LESS WITH A MAXIMUM OF 20 PERCENT PASSING A 200 SIEVE.
- 8) BORROW: AREAS OUTSIDE OF BUILDING AND PAVING LINES SHALL BE COMPACTED TO 90 PERCENT OF MAXIMUM DENSITY (ASSTO D-180) AT OPTIMUM MOISTURE (ASTM D 1556).

PAVING AND DRAINAGE CONSTRUCTION NOTES

- 1) GENERAL - ALL WORKMANSHIP, MATERIALS, AND EQUIPMENT SHALL BE IN ACCORDANCE WITH THE APPLICABLE PORTIONS OF THE ALABAMA DEPARTMENT OF TRANSPORTATION (ADOT), STANDARDS AND SPECIFICATIONS FOR ROAD AND BRIDGE CONSTRUCTION, CURRENT EDITION, ALDOT ROADWAY AND TRAFFIC DESIGN STANDARDS, LATEST EDITION AND THE CITY OF TUSCALOOSA REQUIREMENTS AND SPECIFICATIONS.
- 2) STREET PAVING - SUBGRADE: THE SUBGRADE SHALL BE CONSTRUCTED PER THE STANDARD DETAILS FOUND IN THE PLANS. BASE COURSE: THE BASE COURSE SHALL BE CONSTRUCTED PER THE STANDARD DETAILS FOUND IN THE PLANS. ASPHALT COURSE: THE ASPHALT COURSE SHALL BE CONSTRUCTED PER THE STANDARD DETAILS FOUND IN THE PLANS. CONCRETE CURB: THE CONCRETE CURB SHALL BE CONSTRUCTED PER THE STANDARD DETAILS FOUND IN THE PLANS.
- 3) STORM DRAINAGE - GENERAL UPON COMPLETION, ALL CULVERTS ARE TO BE AT GRADE, UNIFORM ALIGNMENT, FREE OF DEBRIS AND CLEAN. CULVERT PIPE: PIPE FOR CULVERTS SHALL BE REINFORCED CONCRETE. ALL PIPE SHALL BE CLASS III, UNLESS OTHERWISE SPECIFIED ON THE PLANS. ALL LIFTING HOLES ARE TO BE MORTARED AND CLOSED BEFORE BACKFILLING. INLETS AND MANHOLES: DRAINAGE STRUCTURES SHALL BE CONSTRUCTED OF REINFORCED CONCRETE COMPLETE WITH FRAME AND COVERS.
- 4) REPORT OF SUBSURFACE CONDITIONS - NO SUBSURFACE INVESTIGATION HAS BEEN CONDUCTED.
- 5) TESTING - THE OWNER WILL PAY FOR ALL TESTS REQUIRED BY THE CITY OR COUNTY EXCEPT THOSE PROVING TO BE UNSATISFACTORY. THIS INCLUDES ALL FIELD EQUIPMENT, PRESSURE AND LEAKAGE TEST, BACTERIOLOGICAL TESTS FOR PIPE, STRUCTURES, AND ASPHALT MATERIALS. ANY TESTS WHICH HAVE TO BE MADE BECAUSE OF FAILURE OF INSTALLED MATERIALS TO MEET SPECIFICATIONS SHALL BE PAID FOR BY THE CONTRACTOR AND COSTS OF ANY SUCH TEST SHALL BE DEDUCTED FROM PAYMENTS DUE THE CONTRACTOR. THE OWNER WILL RETAIN A CERTIFIED ENGINEERING TESTING LABORATORY TO PERFORM ALL MATERIALS TESTING SPECIFIED IN THE TECHNICAL SPECIFICATION AND AS MAY BE REQUIRED BY THE APPROPRIATE GOVERNMENTAL AGENCY HAVING JURISDICTION.
- 6) SIDEWALKS - SHALL BE CONSTRUCTED, WHERE SHOWN ON THE PLANS, IN ACCORDANCE WITH CITY OR COUNTY STANDARDS. SIDEWALKS SHALL BE MIN. FOUR (4) FEET WIDE AND FOUR (4) INCHES THICK WITH 6x6/10x10 W/F UNLESS OTHERWISE SPECIFIED. COMPACTION UNDER SIDEWALK SHALL BE 98% MAXIMUM DENSITY IN ACCORDANCE WITH ASSHTO 199-70.

CONSTRUCTION SCHEDULE AND TECHNIQUES

THE FILL MATERIAL WILL BE CLEAN FILL SAND FROM A PERMITTED BORROW PIT.

HAYBALES OR SILT SCREEN (SILT FENCE) SHALL BE INSTALLED AT LOCATIONS SHOWN ON THE PLANS AND AROUND THE INLETS AFTER THEIR CONSTRUCTION AND THE EROSION CONTROL SHALL REMAIN IN PLACE UNTIL GROUND AND ROAD CONSTRUCTION IS COMPLETE. REMOVE SILT SCREEN (SILT FENCE) OR HAY BALES AFTER SOIL STABILIZATION.

NO DENATURING IS EXPECTED DURING THE CONSTRUCTION UNLESS INCIDENTAL TO ROAD CONSTRUCTION, GRADING AND UTILITY INSTALLATION.

CS MULLINS
CIVIL & STRUCTURAL ENGINEERS • SURVEYORS
1701 Queen City Avenue, Tuscaloosa, AL 35401 Phone: (205) 752-3702 Fax: (205) 752-8189

REFERENCE NOTES

- CONC. PAVING.
- CRUSHED BRICK WALK. (NON-ACCESSIBLE ROUTE)

GENERAL NOTES

REVISIONS

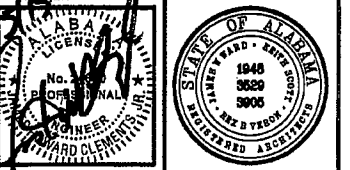

WSV ARCHITECTS

WARD SCOTT VERON ARCHITECTS, INC.
2715 7TH STREET TUSCALOOSA ALABAMA 35401
TEL (205) 345-6110 FAX (205) 345-5696
WWW.WSV-ARCHITECTS.COM

BASEBALL AND SOFTBALL STADIUMS
2800 SOUTH ALABAMA AVENUE
MONROEVILLE, ALABAMA
ALABAMA SOUTHERN COMMUNITY COLLEGE

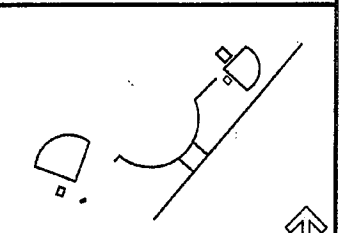

REVISED FINAL SUBMITTAL

DATE: 05/15/07
PROJ NO: 06-015

1 SITE DETAILS Package 'A' & Package 'B' NOT TO SCALE

To order plans, go to www.lidrepro.com

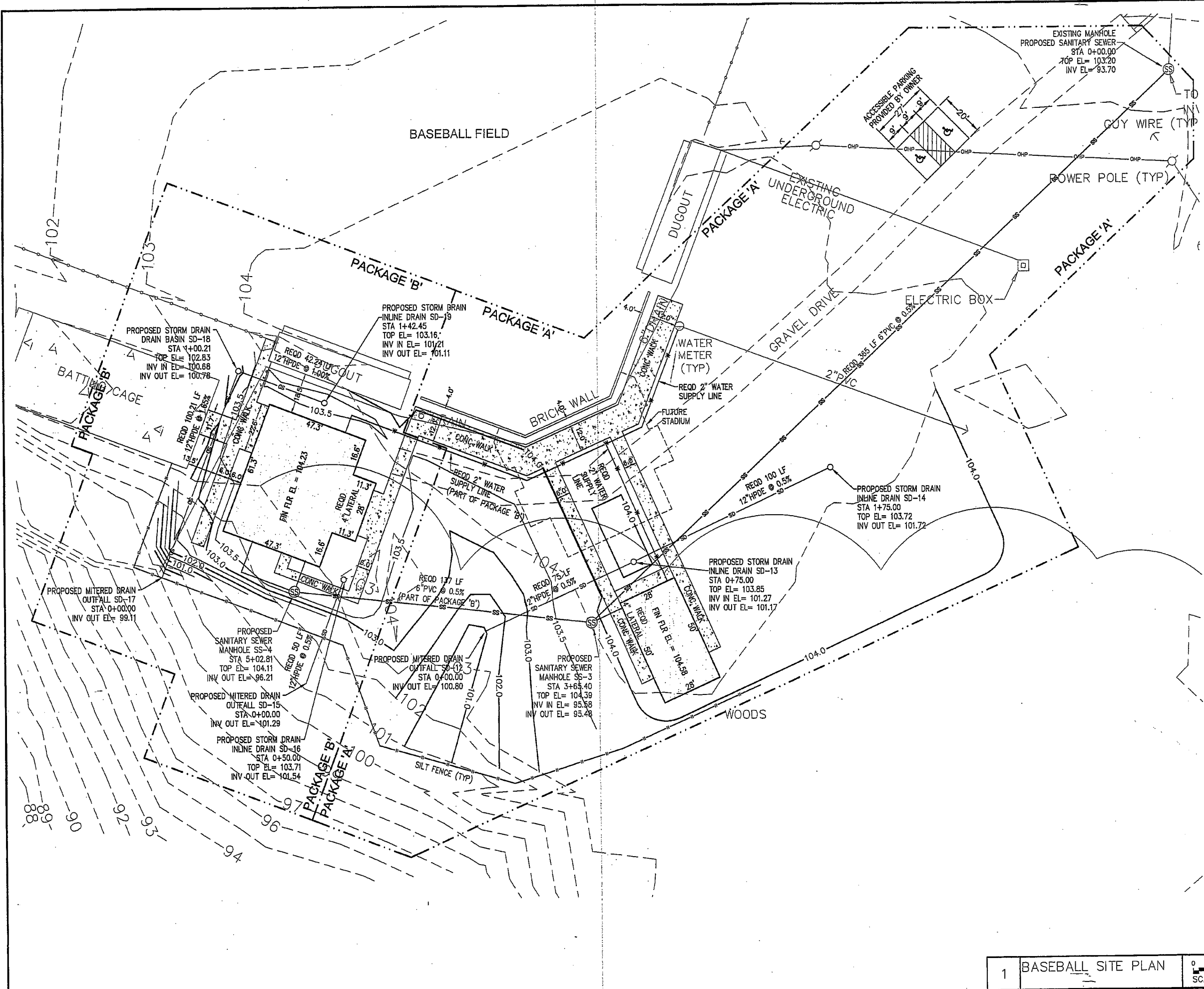

CS MULLINS
 CIVIL & STRUCTURAL ENGINEERS • SURVEYORS
 1701 Queen City Avenue, Tuscaloosa, AL 35401 Phone: (205) 752-3702 Fax: (205) 759-8189

REFERENCE NOTES

	CONC. PAVING.
	CRUSHED BRICK WALK. (NON-ACCESSIBLE ROUTE)

GENERAL NOTES

REVISIONS

Professional Engineer Seal for W. Scott Veron, State of Alabama, License No. 24143, Exp. 12/31/2006.

WSV ARCHITECTS
 WARD SCOTT VERON ARCHITECTS, INC.
 2715 7TH STREET TUSCALOOSA ALABAMA 35401
 TEL (205) 345-6110 FAX (205) 345-6696
 WWW.WSV-ARCHITECTS.COM

BASEBALL AND SOFTBALL STADIUMS
 2800 SOUTH ALABAMA AVENUE
 MONROEVILLE, ALABAMA
 ALABAMA SOUTHERN COMMUNITY COLLEGE

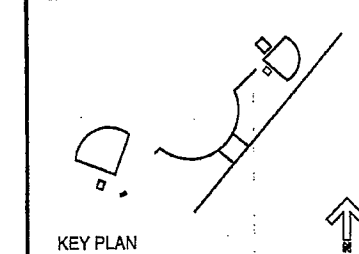

REVISED FINAL SUBMITTAL	BASEBALL SITE PLAN
DATE: 05/15/07 PROJ NO: 06-015	C101

1 BASEBALL SITE PLAN
 SCALE: 1" = 20'

To order plans, go to www.lidirepro.com

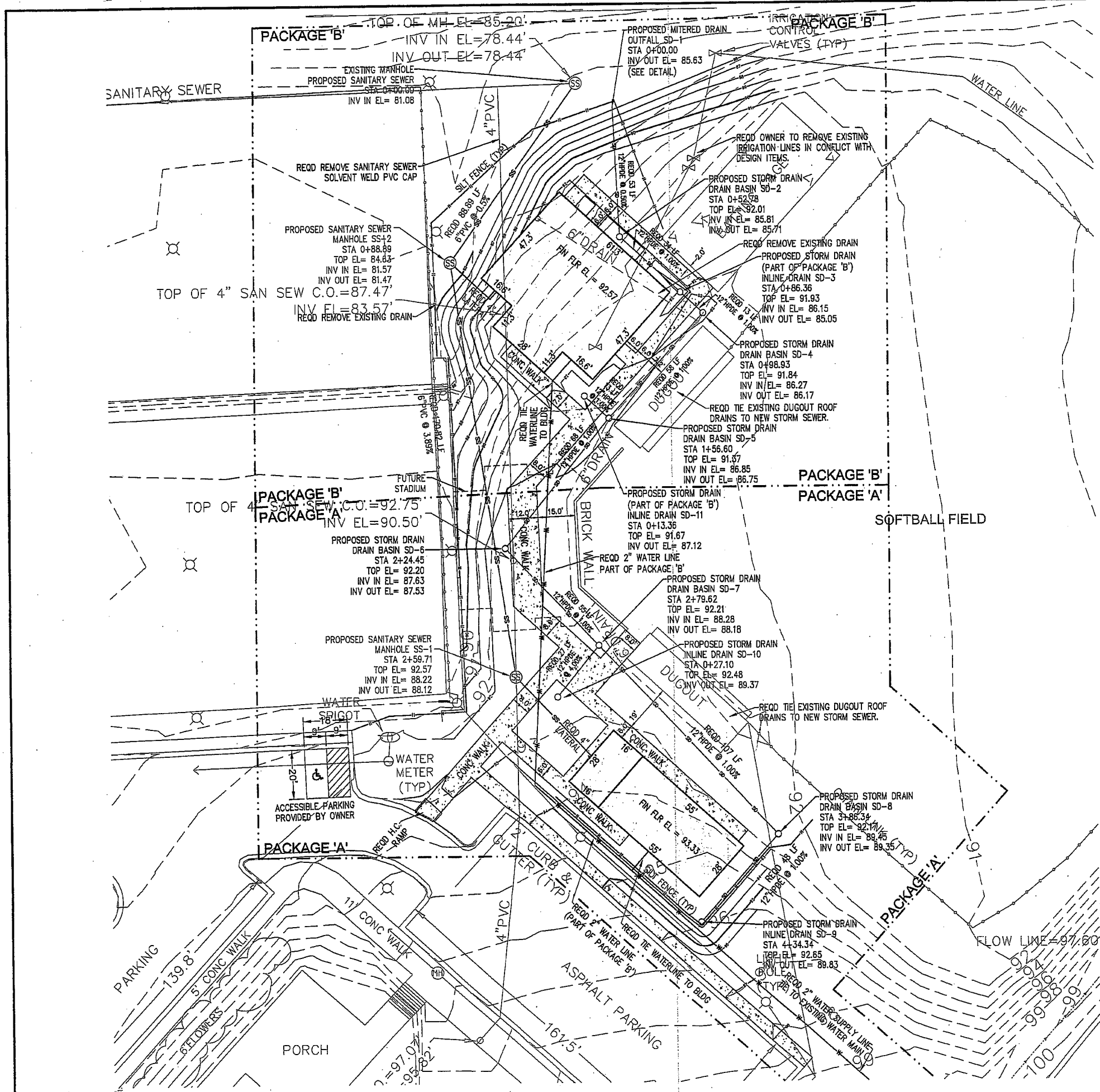

SS MULLINS
 CIVIL & STRUCTURAL ENGINEERS • SURVEYORS
 1701 Queen City Avenue, Tuscaloosa, AL 35401 Phone: (205) 752-3702 Fax: (205) 758-9168

REFERENCE NOTES
 CONC. PAVING.
 CRUSHED BRICK WALK. (NON-ACCESSIBLE ROUTE)

GENERAL NOTES

REVISIONS

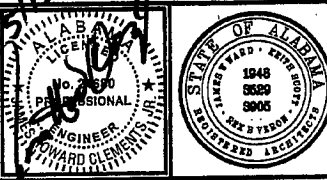

WSV ARCHITECTS

WARD SCOTT VERON ARCHITECTS, INC.
 2715 7TH STREET TUSCALOOSA ALABAMA 35401
 TEL (205) 345-6110 FAX (205) 345-6696
 WWW.WSV-ARCHITECTS.COM

BASEBALL AND SOFTBALL STADIUMS
 2800 SOUTH ALABAMA AVENUE
 MONROEVILLE, ALABAMA
 ALABAMA SOUTHERN COMMUNITY COLLEGE

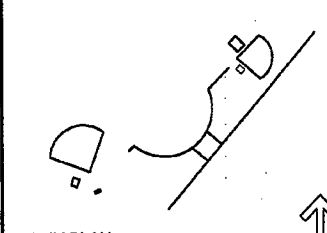

REVISED FINAL SUBMITTAL

DATE: 05/15/07
 PROJ NO: 06-015

1 SOFTBALL SITE PLAN

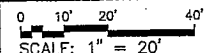

C201

To order plans, go to www.idirepro.com